

## **ACCCFM** electronic control

ACCCFM is an electronic device to drive AC single-phase electric motor. It's especially dedicated to the linear speed regulation of fan coils. With a thermostat with proportional signal output type 0/10V or PWM, thanks to ACCCFM it is now possible to carry out a linear speed regulation of the fan. The thermostat will be connected to ACCCFM by means of two signal wires and so it can be easily placed in any point of the ambient where the fan coil is

## General features

ACCCFM	
Features	Value
<b>ANALOG INPUTS</b>	
0/10V o PWM (1kHz)	1
<b>MOTOR CONTROL OUTPUT</b>	
230Vac, 0.6A RMS maximum	1
<b>POWER SUPPLY</b>	
230Vac, 50Hz	.
<b>OTHERS</b>	
Connectors	Fast-on type
Dimensions (DIN module)	8
Mounting	DIN bar

## Connections specifications

CONNECTORS	NUMBER OF WAY	CONNECTIONS	FEATURES
Input	3	0-10V, COM, PWM	Input PWM and 0-10V
Motor control	2	230Vac	Motor control 230Vac - 50-60Hz - 0.6A
Power supply	2	230Vac	Power supply 230Vac - 50-60Hz

## Connections specification diagram

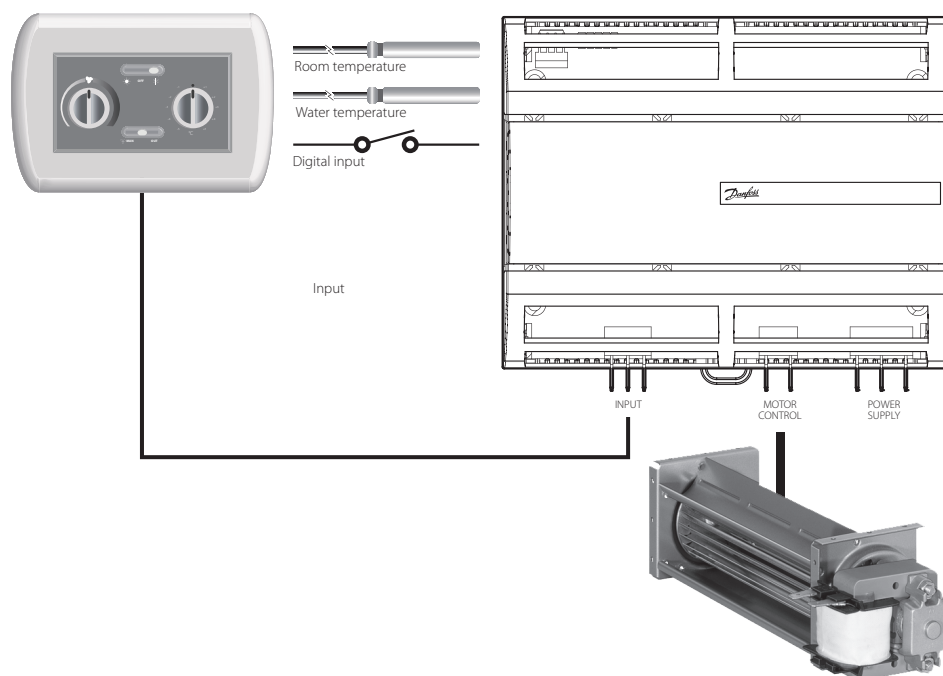

## Connection diagram

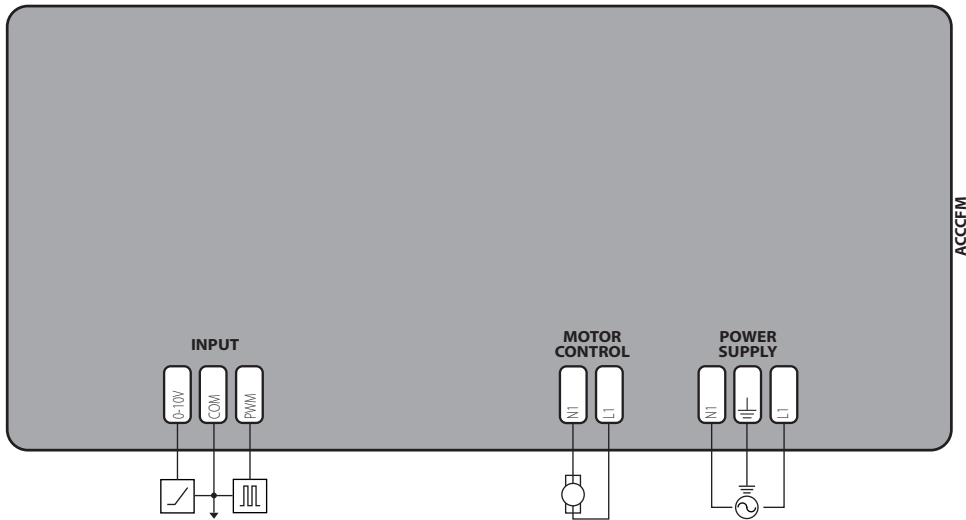

## Dimensions

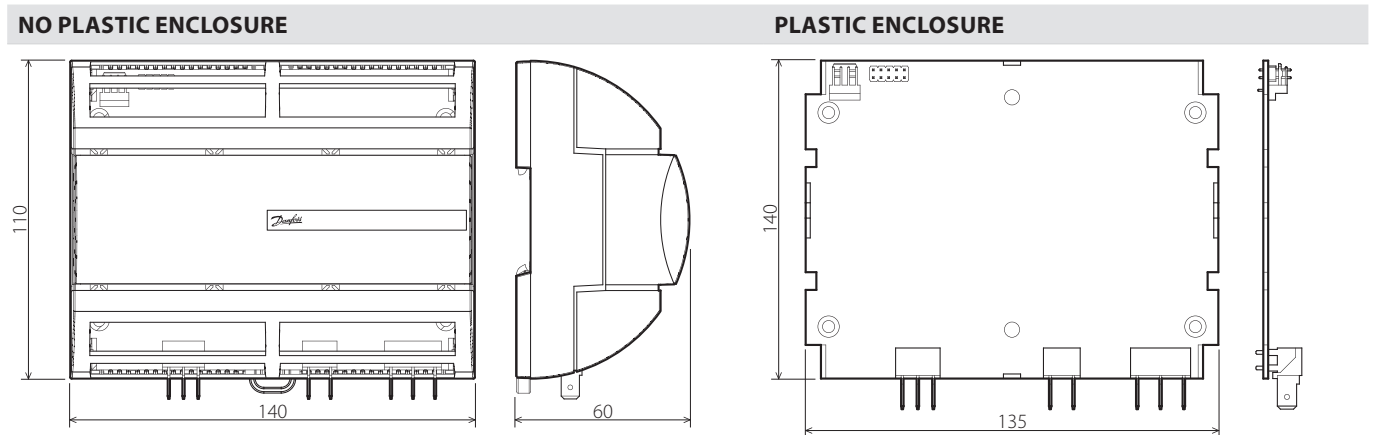

## Product part numbers

ACCCFM	
CODE *	DESCRIPTION
080G0157	ACCCFM, 230V, 0-10V, PWM, NO PLASTIC ENCLOSURE, I
080G0158	ACCCFM, 230V, 0-10V, PWM, I

\*NOTE: industrial pack codes (I) don't include standard kit connectors



Danfoss Electronics spa

Viale Venezia, 59  
31020 San Vendemiano  
(TV) Italy

Tel: +39 0438 336611  
Fax: +39 0438 336699

[info@danfosselectronics.com](mailto:info@danfosselectronics.com)  
[www.danfosselectronics.com](http://www.danfosselectronics.com)